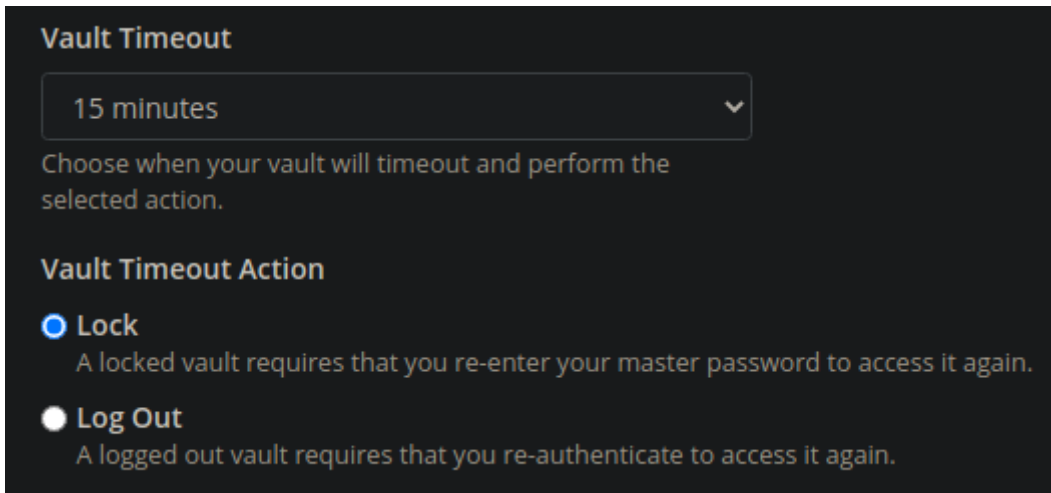

# Client Settings

## Common Settings

### Vault Locking

A screenshot of a settings panel with a dark background. At the top, the text "Vault Timeout" is displayed in a light color. Below it is a dropdown menu showing "15 minutes" with a downward arrow. Underneath the dropdown is a line of text: "Choose when your vault will timeout and perform the selected action." Further down, the text "Vault Timeout Action" is shown. Below this are two radio button options. The first option is "Lock", which is selected (indicated by a blue dot), and has a description: "A locked vault requires that you re-enter your master password to access it again." The second option is "Log Out", which is not selected (indicated by a white dot), and has a description: "A logged out vault requires that you re-authenticate to access it again."

There are two common settings - when to timeout, and what to do when it gets timed out. The above should be self-explanatory. The settings are different for the Browser Add-On which allows for the timeout to be the screenlock and/or a computer restart. The mobile app allows for an App Restart timeout.

## Change Master Password

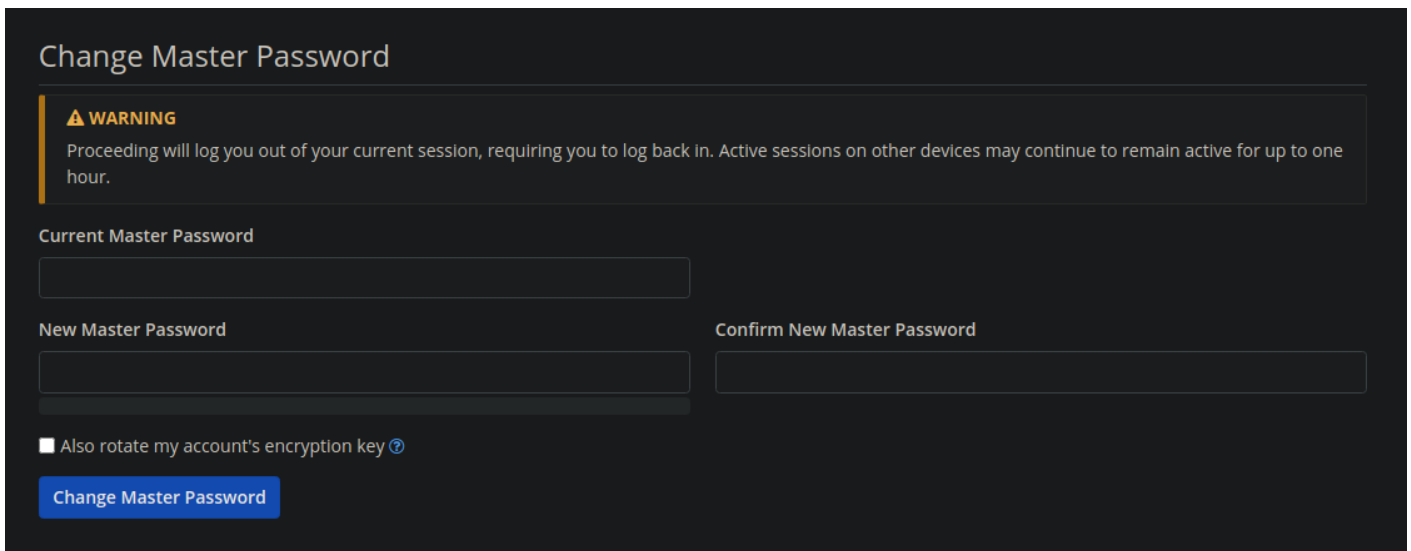

Change Master Password

**⚠ WARNING**  
Proceeding will log you out of your current session, requiring you to log back in. Active sessions on other devices may continue to remain active for up to one hour.

Current Master Password

New Master Password

Confirm New Master Password

☐ Also rotate my account's encryption key [?](#)

Change Master Password

There are options on the other clients to do this, but they redirect to the web vault.

# Web App

## Display layout

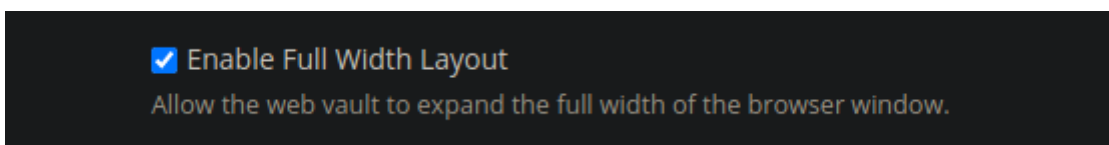

☒ Enable Full Width Layout  
Allow the web vault to expand the full width of the browser window.

This allows the web vault to display using the whole width of your screen. Just a nice QOL improvement.

# Browser Add-On & Mobile Client

## Server URL

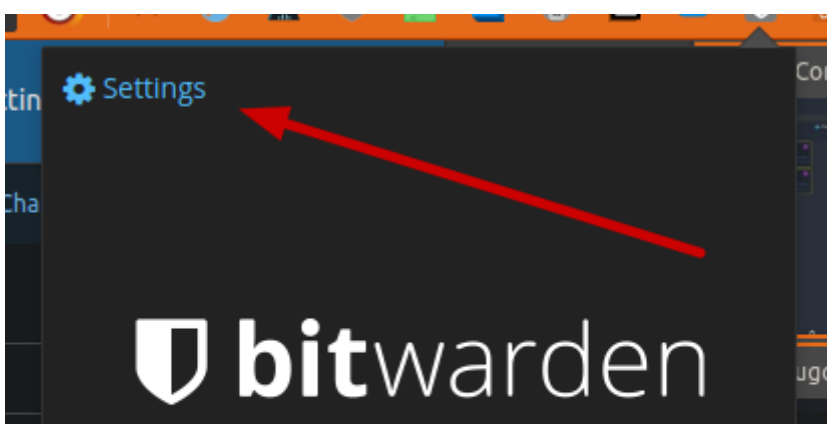

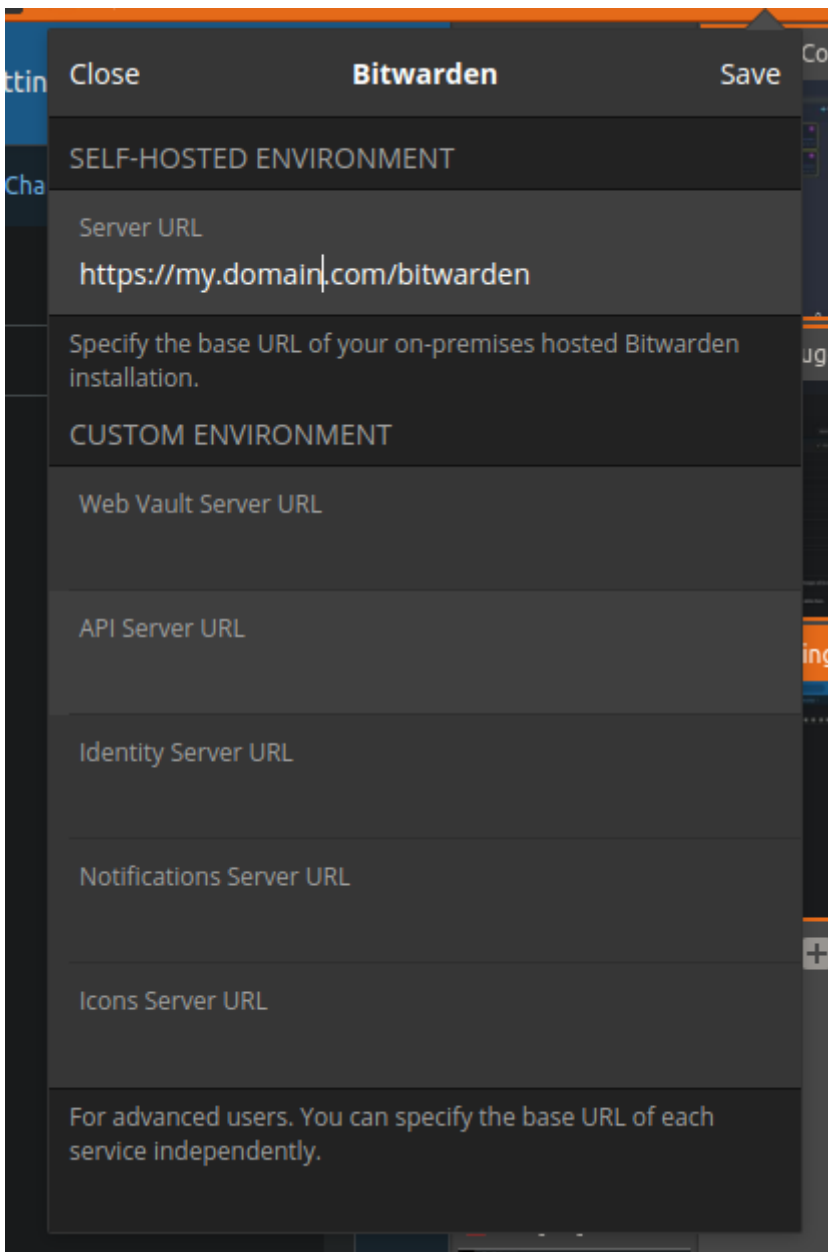

Your URL should include the `/bitwarden` path at the end of the domain.

## Unlock with Biometrics/PIN Code

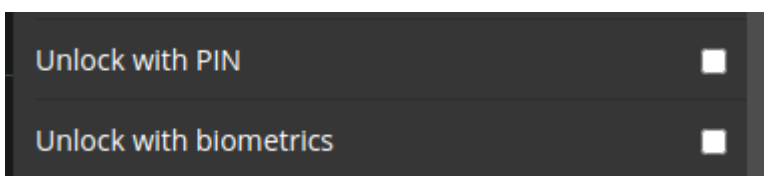

This allows you to log in using a PIN or biometrics (fingerprint reader on mobile, etc.). This is much more convenient after setting up a device than having to re-type your master password over and over again.

# Dark Theme

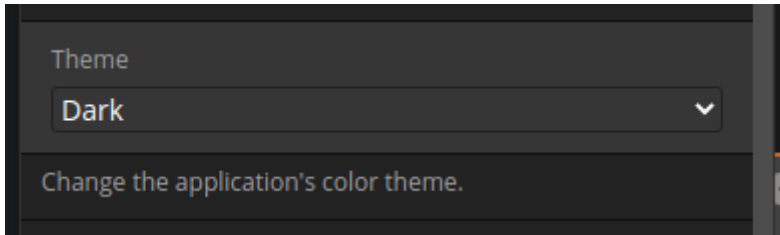

The only sane choice.

# Auto-Fill

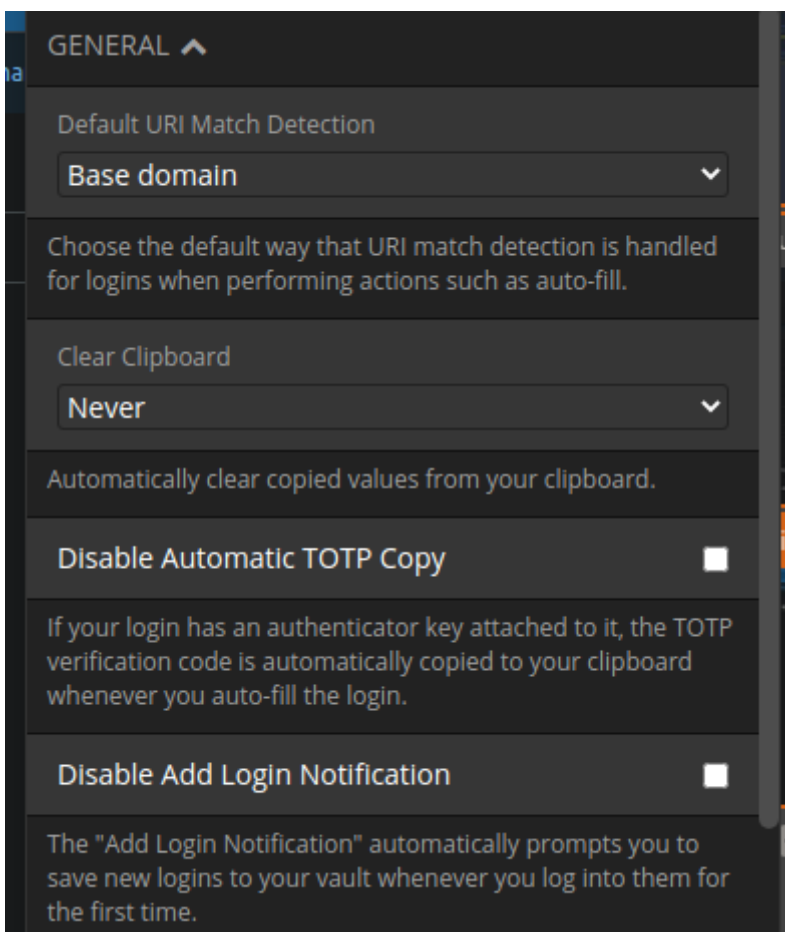

The explanations are above, but I would suggest setting these the way that seems best to you.

Note that if you don't have the URI saved for a site, but are using Bitwarden anyways, it will prompt you to add it to a new entry instead of the existing one.

# Sync

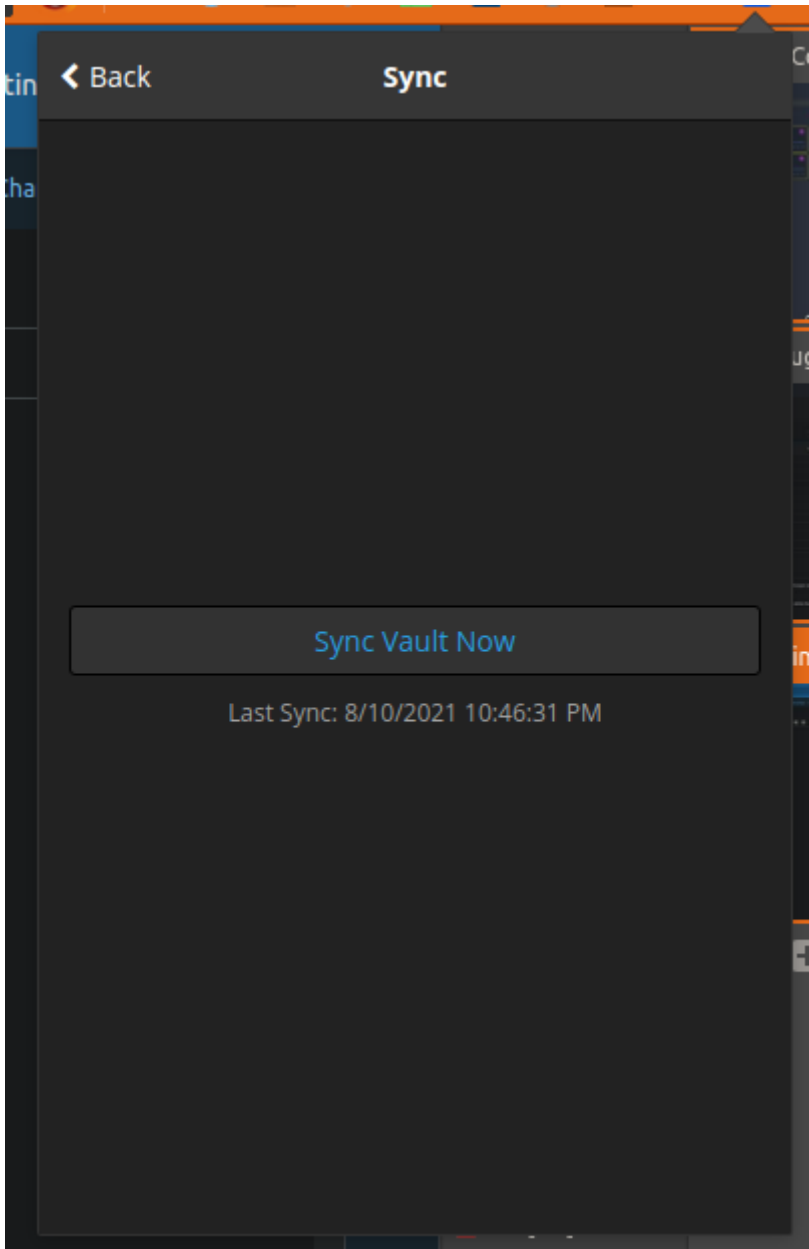
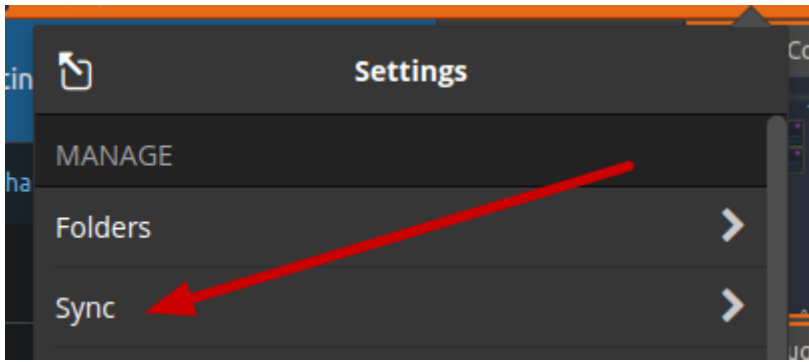

This is to manually sync the clients. However, the clients sync any time there is a change as described in <https://bitwarden.com/blog/post/live-sync/>

# Desktop Client

## CLI

---

Revision #2

Created 13 July 2021 00:13:04 by andrewcz

Updated 11 August 2021 03:13:36 by andrewcz